

### FOR "T" GROOVE CYLINDERS

CYLINDERS		Leaflet	cylinder Ø	CODE FASTENING KIT
Type	Series			
- PEC	449	P226	32 ... 100	(1)
- PES 453	453	P229	32 ... 100	
- PLS 452	452	P229	32 ... 100	
- PES Ω	453	P239	32 ... 80	
- CSC	CSC	P226B	20 ... 80	
- CGT	CGT	-	16 ... 63	

(1) Fastening mini-kit (special nut + screw) supplied **with** detectors

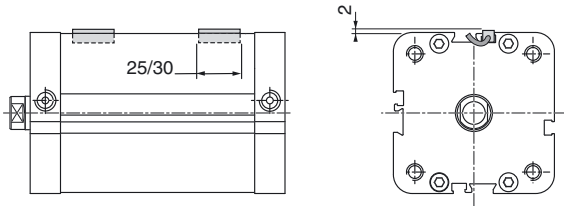

NOTE:

PEC cylinders

PES 453 cylinders Ø 32

- : 3 grooves «T»
- 1 dovetail grooves
- Ø 40 mm : 4 grooves «T»
- 1 dovetail grooves
- Ø 50 mm : 5 grooves «T»
- 1 dovetail grooves
- Ø 63-100 mm : 4 grooves «T»
- 4 dovetail grooves

In order to control **the max. end** of cylinder stroke, the detectors must be mounted in the following direction:

**PEC cylinder:**

Ø32-40: cable oriented towards the middle of the cylinder  
Ø50-100: any position

**PES 453 cylinder:**

Ø32-40: cable oriented towards the middle of the cylinder  
Ø50-100: any position

### FOR DOVETAIL GROOVE CYLINDERS

CYLINDERS		Leaflet	cylinder Ø	CODE FASTENING KIT	
Type	Series			lead outlet version	M8 connector integrated version
- K	441	P215	8 ... 100	N199-1163	N99-1185
- P2L-P2B	447	P275	16 ... 32		
- PES	453	P229	32 ... 100		
- CSC	CSC	P226B	20 ... 80		

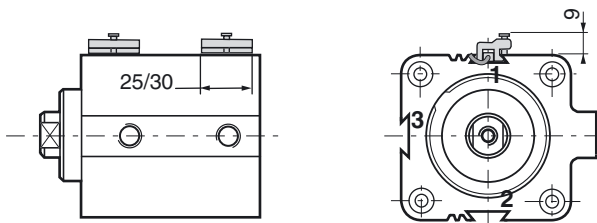

NOTA :

K cylinders

- Ø 8 - 12 mm : 2 grooves en 1 et 2
- Ø 16 - 100 mm : 3 grooves en 1,2 et 3

In order to control **the max. end** of cylinder stroke, the detectors must be mounted in the following direction:

**K cylinder:**

Ø8-10-12-16 equipped with MR detector, the detector protrudes of 5mm from cylinder external fronts

Ø8-10-12: cable oriented towards the middle of the cylinder

Ø16 front cover: any position

Ø16 rear cover: cable oriented towards the middle of the cylinder

**P2B/P2L cylinders** : any position

### FOR TIE RODS CYLINDERS

CYLINDERS		Leaflet	cylinder Ø	CODE FASTENING KIT	
Type	Series			lead outlet version	M8 connector integrated version
- PCN	437	P245	25	N199-1051	N99-1183
- PES	450	P232	32-40	N199-1047	
- PES Ω	450	P234	50-63-80	N199-1048	
- PES Ω	450	P234	100	N199-1049	
- PCN	437	P245	125	N199-1050	N99-1184
			160-200	N199-1050	

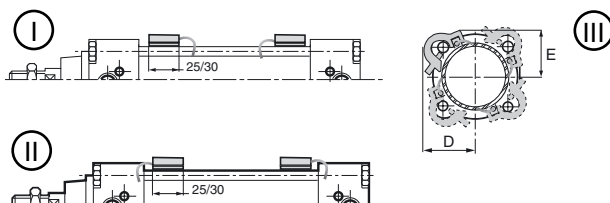

Ø cylinder	25	32	40	50	63	80	100	125	160	200
D	24	30	33	38	44	50	69	77	89	104
E	24	26	30	35	39	49	61	69	87	101

Ⓛ It is possible to fasten the detector with its electric outlet to the centre of the cylinder (in order to be able to control the **max. end** of travel of the cylinder)

Ⓜ In order to fasten the detector with its electric outlet to the rear, rotate **the unit** detector + collar by 180°

Ⓝ The detectors can be mounted on any one of the 4 **tie rods**.



### FOR ROUND CYLINDERS

CYLINDERS		Leaflet	cylinder Ø	CODE FASTENING KIT	
Type	Series			plastic	stainless steel AISI 303 + 304
- C.AS - CIS - CIX	435 438 435	P220 P225 P252 P255	8-10	-	<b>N199-1037</b>
			12	<b>N199-1038</b>	<b>N199-1054</b>
			16	<b>N199-1039</b>	<b>N199-1054</b>
			20	<b>N199-1040</b>	<b>N199-1055</b>
			25	<b>N199-1041</b>	<b>N199-1055</b>
			32	<b>N199-1042</b>	<b>N199-1056</b>
			40	<b>N199-1043</b>	<b>N199-1058</b>
			50	-	<b>N199-1044</b>
63	-	<b>N199-1045</b>			
80	-	<b>N199-1046</b>			
- PIS	<b>436</b>	P243	250	-	<b>N199-1063</b>

Ø 12 to 40 mm

Ø 8 to 80 mm

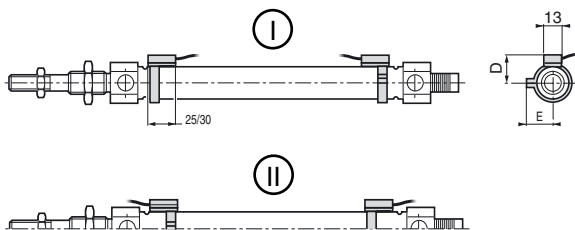
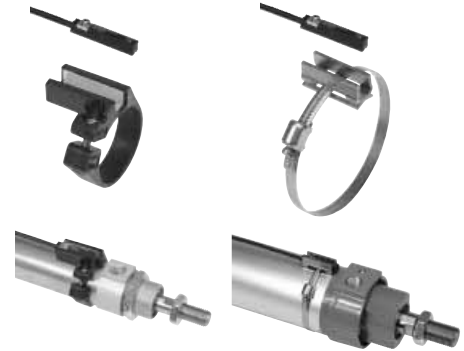

It is possible to mount magnetic detectors for **intermediate** position indication : mounting by collar

Ø 8-20 : any position.

Ø 25-80 : cable oriented towards the cylinder ends

Ø cylinder	8	10	12	16	20	25	32	40	50	63
D	14,5	15,5	15	16,5	19	21,5	26,5	31	38	45
E	13,5	14,5	16,5	19	20,5	23	29,5	31,5	36,5	43,5

I On all diameters, it is possible to mount the detector with its electrical outlet facing towards the cylinder barrel (in order to be able to control the **max. end** of travel of the cylinder).

II In order to fasten the detector on cylinder diameters 25 to 63 with its electrical outlet facing towards the cylinder ends, rotate the detector + collar **unit** by 180°.

### FOR PROFILED BARREL CYLINDERS



CYLINDERS		Leaflet	cylinder Ø	CODE FASTENING KIT
Type	Series			
- PES 450	450	P230	32-40 50-63 80-100-125	<b>N199-1047</b> <b>N199-1048</b> <b>N199-1049</b>

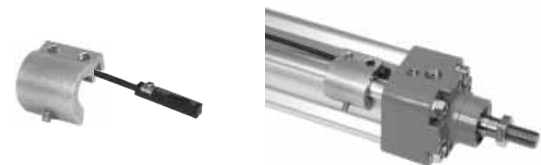

Ø cylinder	32	40	50	63	80	100	125
D	28	32	37	41	58	65	73
E	28	31	36	40	54	62	73

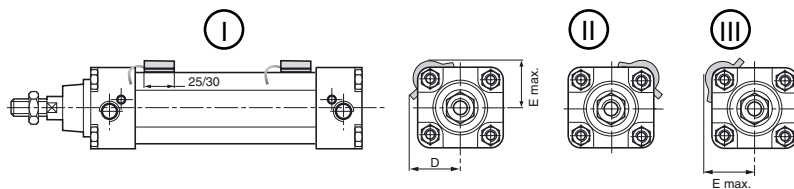

- I It is possible to mount additional magnetic detectors for **intermediate** position indication.
- II In order to fasten the detector with its electric outlet to the rear, mount the detector + the mounting bracket.
- III The detectors can be mounted on any one of the 4 **bosses**.